

Specifications

Dimensions

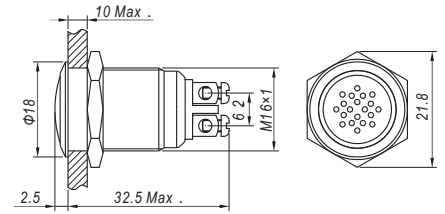

Mounting Hole Diameter: $\Phi 16\text{mm}$
 Sound Type(□): Continuous Sound(M) / Discontinuous Sound(JM)
 Supply Voltage(▲): DC12V / DC24V
 Rated Current: $\leq 30\text{mA}$
 Buzzer Volume: $\geq 85\text{dB}$ (at 0.1m distance) / $\geq 75\text{dB}$ (at 1m distance)
 Body Material: Stainless Steel
 IP Rating: IP40, IK04



Mounting Hole Diameter: $\Phi 19\text{mm}$
 Sound Type(□): Continuous Sound(M) / Discontinuous Sound(JM)
 Supply Voltage(▲): DC12V / DC24V
 Rated Current: $\leq 30\text{mA}$
 Buzzer Volume: $\geq 85\text{dB}$ (at 0.1m distance) / $\geq 75\text{dB}$ (at 1m distance)
 Body Material: Stainless Steel
 IP Rating: IP40, IK04

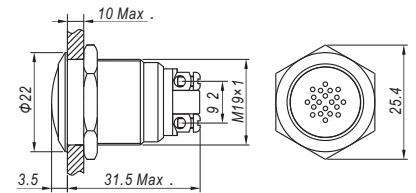

Mounting Hole Diameter: $\Phi 19\text{mm}$
 Sound Type: Flashing Buzzer(SM)
 LED Color(△): R Other color can be customized
 Supply Voltage(▲): DC12V / DC24V
 Rated Current: $\leq 30\text{mA}$
 Buzzer Volume: $\geq 85\text{dB}$ (at 0.1m distance) / $\geq 75\text{dB}$ (at 1m distance)
 Body Material: Stainless Steel
 IP Rating: IP40, IK04

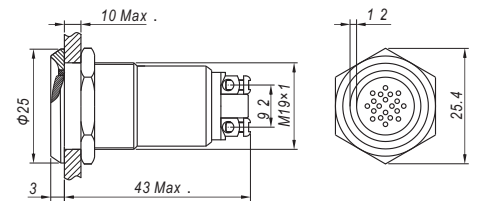

Mounting Hole Diameter: $\Phi 19\text{mm}$
 Sound Type(□): Continuous Sound(M) / Discontinuous Sound(JM)
 Supply Voltage(▲): DC12V / DC24V
 Rated Current: $\leq 30\text{mA}$
 Buzzer Volume: $\geq 85\text{dB}$ (at 0.1m distance) / $\geq 75\text{dB}$ (at 1m distance)
 Body Material: Stainless Steel
 IP Rating: IP40, IK04

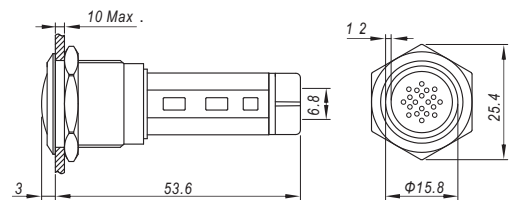

Mounting Hole Diameter: $\Phi 19\text{mm}$
 Sound Type: Flashing Buzzer(SM)
 LED Color(△): R Other color can be customized
 Supply Voltage(▲): DC12V / DC24V
 Rated Current: $\leq 30\text{mA}$
 Buzzer Volume: $\geq 85\text{dB}$ (at 0.1m distance) / $\geq 75\text{dB}$ (at 1m distance)
 Body Material: Stainless Steel
 IP Rating: IP40, IK04

