

REV.	EQ. NO.	REVISE. NO.	REVISER	APPD.
版本	ECN: 编号	次数	修订者	核准
R1	DRAWING			

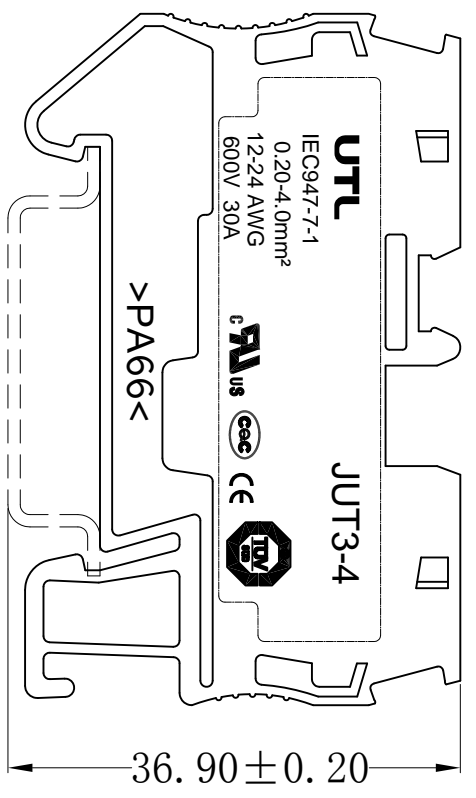
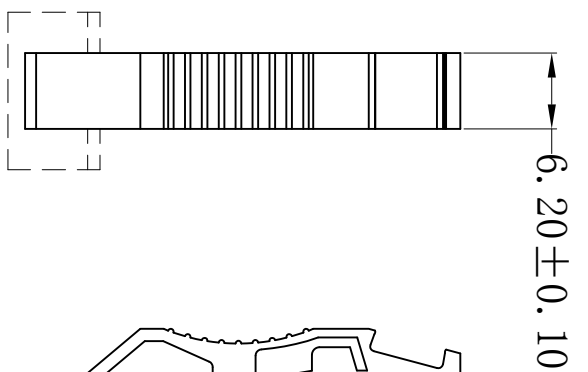
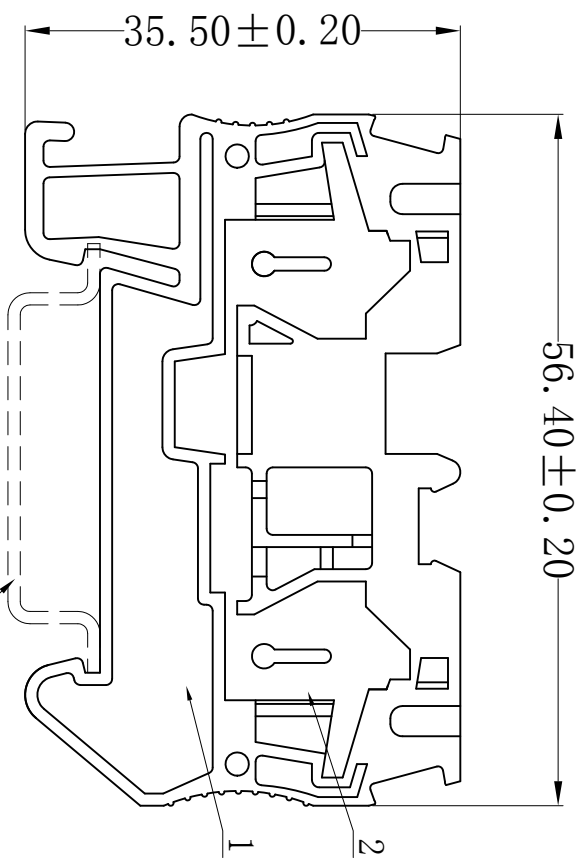

Technical Data

Material:

Body: PA66 UL94 V-0.

Conductor: Copper, Tin Plated.

Spring: SUS 301.

Electrical:

Voltage rating/Current rating: IEC 800V/32 A;
UL 600V/30 A

Contact resistance: 20 mΩMax.

Insulation resistance: 500V, 500 MΩMin.

Withstanding Voltage: AC 3000 V, 1 minute.

Mechanical:

Connection Capacity: 24-12AWG.

Stripping Length: 12mm.

Operating temperature: -45° C to +105° C.



ZHEJIANG UTILITY ELECTRICAL CO., LTD
浙江尤提乐电气有限公司

TYPE NO.	TITLE	SCALE	PAGE
>120	名称: Customer Drawing	FULL	1/1
>30~120	型号: JUT3-4-M101	比例:	页码:
>6~30	批准: APPD.	图号: C-DW0254-0	版本: R1
0~6	审核: CHKD.	UNIT: mm[inch]	
MATL 材质:	设计: DR. Jammy. ling		